



GUTEX Thermofloor

TECHNICAL DATA SHEET



GUTEX Thermofloor is the impact sound insulation board for all floor constructions with live loads of up to 5 kN/m².

Ingredients

- Untreated fir and spruce
- For 30 mm board thickness 2.0 % PVA glue for two-layer strip bonding

Disposal

- Waste code numbers as per AVV 030105, 170201

Bulk density ρ [kg/m ³]	~ 160
Nominal thermal conductivity λ_D [W/mK]	0.040
Vapour diffusion μ	5
Dynamic stiffness [MN/m ³]	≤ 30
Compressibility with live loads ≤ 5 kPa [mm]	2
Air flow resistivity [kPa s/m ²]	≥ 100
Specific heat capacity [J/kgK]	2100
Maximum working temperature [°C]	110
Fire reaction Euro Class as per EN 13501-1	E
Product standard	EN 13171
Board designation	WF-EN13171-T7-SD30-CP2-MU5-AF _r 100





GUTEX Thermofloor

Detailed information

Joint type	Flush-mount	
Thickness [mm]	20	30
Length × width [mm × mm]	1200 × 600	
m ² /Piece(s)	0.72	
Weight per board [kg]	2.30	3.50
Weight per m ² [kg]	3.20	4.80
Piece(s)/Pallet	180	120
Square metres per pallet [m ²]	129.60	86.40
Weight per pallet [kg]	450	
Nominal thermal resistance R _D [m ² K/W]	0.50	0.75
sd value [m]	0.10	0.15



GUTEX Thermofloor

PRODUCT INFORMATION

Areas of use

- Underfloor air, impact sound, and thermal insulation
 - Wet screed (cement, anhydrite, etc.)
 - Mastic asphalt
 - Dry screed elements

Advantages

- Excellent air and impact sound insulation
- Live loads up to 5 kN/m² (excluding dry screed elements)
- Diverse areas of use
- High dimensional accuracy for time-saving and simple installation
- Optimum thermal insulation
- Outstanding heat storage capacity → good protection from heat in summer and cold in winter
- Improves sound insulation
- Moisture-regulating
- Vapour-permeable
- Wood as the sustainable raw material → recyclable
- Manufactured in Germany (Black Forest)
- Ecologically safe (natureplus® certified)

Installation instructions

- Store and work with the boards in a dry place
- Install in one or two layers, maximum thickness 60 mm, see table
- Use GUTEX Thermosafe-wd for higher insulation thicknesses (max. 100 mm)
- Create a dry, level, and technically perfect substrate
- If necessary, install a moisture barrier
- Use trickle protection paper for wood joist ceilings
- Apply edge strips at the height of the entire structure
- Cut to size: GUTEX cutting blade for jigsaws or portable circular saw with extractor unit
- Install GUTEX Thermofloor in a bond pattern. The remaining piece in one installation row is placed at the beginning of the next row (see installation diagram). Apply edge strips at the height of the entire structure
- Note the legal requirements for handling wood dust

Floor structure

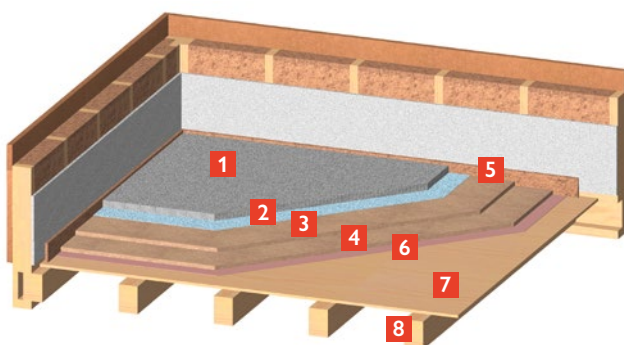

- 1 Wet screed
- 2 Moisture-protection film
- 3 GUTEX Thermofloor 30 mm
- 4 GUTEX Thermofloor 30 mm
- 5 Edge strip
- 6 Trickle protection paper
- 7 Exposed formwork
- 8 Visible beam layer



Installation diagram

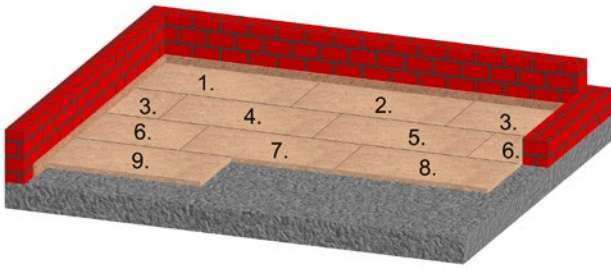

Insulation structure

Covering on GUTEX Thermofloor	GUTEX Thermofloor maximum thickness
Wet screed (cement, anhydrite, etc.)	60 mm (2 x 30 mm)
Mastic asphalt	60 mm (2 x 30 mm)
Chipboard \geq 25 mm	30 mm (1 x 30 mm)
OSB board \geq 22 mm	30 mm (1 x 30 mm)
Dry screed element \geq 25 mm	20 mm (1 x 20 mm)