



Photographic images are property of GUTEX archive

GUTEX Thermosafe-wd, an insulating board with singly construction and homogenous cross section, features exceptionally high compression resistance. It is ideal for any wall or floor structure.

Technical Data	Thermosafe-wd
Joint type	Butted
Thickness (mm)	20/30/40/60/ 80/100/ 120
Length x width (mm)	1250 x 600
Actual coverage (mm)	1250 x 600
Square metres per board (m ²)	0.75
Weight per board (kg)	2.1/3.2/4.2/ 6.3/8.4/10.5 /12.6
Weight per m ² (kg)	2.8/4.2/5.6/ 8.4/11.2/14/ 16.8
Boards per pallet	224/140/ 112/70/ 56/42/36
Square metres per pallet (m ²)	168/105/ 84/52,5/ 42/31,5/27
Weight per pallet (kg)	490
Bulk density (kg/m ³)	140
Nominal thermal conductivity λ_D (W/mK)	0.040
Nominal thermal resistance R_D (m ² K/W)	0.50/0.75/1.00 /1.50/2.00/ 2.50/3.00
Vapour diffusion factor (μ)	3
sd-value (m)	0.06/0.09/ 0.12/0.18/ 0.24/0.30/0.36
Compressive stress/ strength (kPa)	70
Air flow resistivity (kPa s/m ²)	100
Specific heat capacity (J/kgK)	2100
Fire reaction Euro Class as per EN 13501-1	E

European Union	
Nominal thermal conductivity λ_D (W/mK)	0.040
Nominal thermal resistance R_D (m ² K/W)	0.50/0.75/1.00 /1.50/2.00/ 2.50/3.00



Composition

- Manufactured from untreated Black Forest spruce and fir
- Additive: 4 % polyurethane resin

Applications

- Insulation under screed and floor coverings
- Above and between rafter insulation
- Interior insulation of ceilings, walls, floors or roofs
- Insulation of timber frame and prefab modular house sections
- Insulation of top storey ceilings

Advantages

- Excellent thermal insulation properties: $\lambda=0.040$ W/mK
- Outstanding thermal storage capacity provides excellent insulation against heat in the summer and cold in winter
- Significantly improves soundproofing
- Regulates humidity and is vapour diffusion permeable
- Compression resistant
- Manufactured from wood, a sustainable, recyclable natural resource
- Made in Germany
- Biologically safe (natureplus® certified)

Designation:WF-EN 13171-T4-CS(10/Y)70-MU3-AF100

German disposal category:A2 (treated wood; without non-halogenated organic compounds);
code number as per AVV-030105; 170201

Installation

- Store and install this product dry.
- Offset the joints if installing multiple layers.
- Avoid cross joints.
- For best cutting results, use GUTEX blades for jigsaws or handheld circular saws and a vacuum fitting.
- Vacuum off the dust in accordance with applicable workplace safety regulations or practices.
- Substrate must be dry, even and technically sound.
- Protect this product against moisture.
- Edge stripping must be as high as the total built-up height of the floor.

Maximum Built-up Height

Floor Covering over GUTEX Thermosafe-wd	Maximum Built-up Height GUTEX Thermosafe-wd
Wet screed	140 mm
Mastic asphalt	140 mm
Sub-floor fibreboard ≥ 25 mm	140 mm
OSB sub-floor board ≥ 22 mm	140 mm
GUTEX Thermosafe-nf	100 mm
Gypsum screed elements ≥ 25 mm	100 mm
Prefinished engineered wood flooring ≥ 14 mm	30 mm
Laminate flooring ≥ 8 mm	20 mm

Layout Pattern

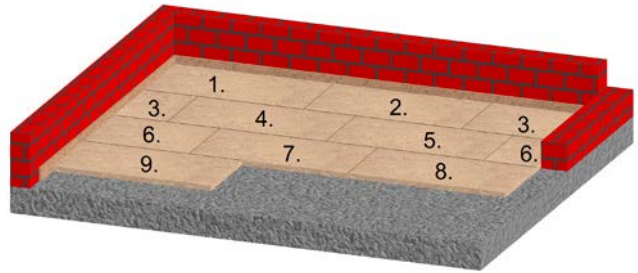

GUTEX Thermosafe-wd installs in offset joint arrangement. Use the oddment of the last board of a row to start the next row (refer to layout plan).

Floor Construction

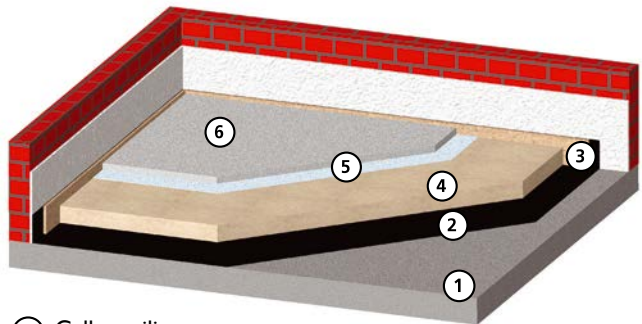

- ① Cellar ceiling
- ② Moisture barrier is required
- ③ Edge strips
- ④ GUTEX Thermosafe-wd
- ⑤ Moisture barrier
- ⑥ Wet screed

All rights reserved. Henselmann GmbH + Co KG is not liable for any damage resulting from error or misprinting. The technical data provided herein is subject to change. Although all of the information was current at the time of its publication, the publication of superseding

information renders the old information invalid.

The suitability of this product for applications not specified in this data sheet is not guaranteed. Warranty and liability claims are subject to the terms of GUTEX's General Terms of Business.



NATURALLY MADE FROM WOOD